



DC-18 GHz

COAXIAL ADAPTER TYPE N

- Low VSWR
- Stainless Steel Precision Connectors

SPECIFICATIONS

FREQUENCY RANGE (GHz)	MODEL	VSWR (Max)	WEIGHT (Max)		CONNECTORS
			Oz	Gr	
DC-18	55	1.25	1.5	43	SMA-F to N-M
	56	1.25	2	57	SMA-M to N-M
	57	1.25	1.5	43	SMA-M to N-F
	58	1.25	1	28	SMA-F to N-F
	76	1.20	2.5	71	N-M to N-M
	77	1.20	2.5	71	N-F to N-F

Adapters

OUTLINE DRAWINGS

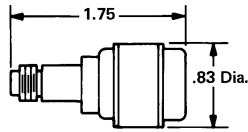

Model 55
SMA-F to N-M

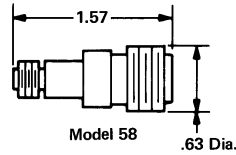

Model 58
SMA-F to N-F

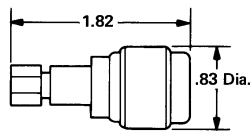

Model 56
SMA-M to N-M

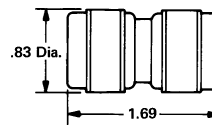

Model 76
N-M to N-M

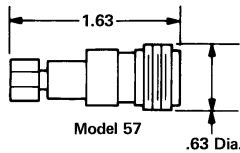

Model 57
SMA-M to NF

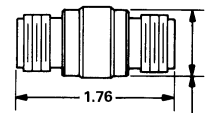

Model 77
N-F to N-F

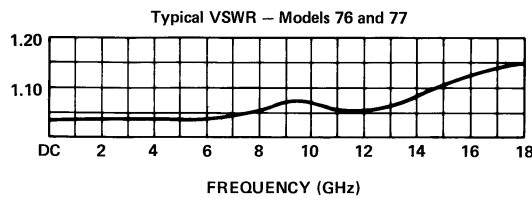
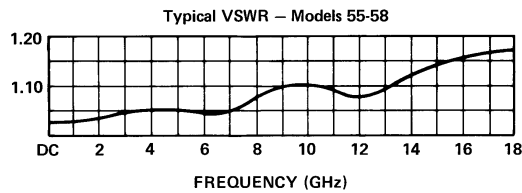

All dimensions are Max. unless otherwise specified.